

NOTES

1 MATERIAL: 6061 ALUMINUM (EXCEPT FOR CONNECTORS AND DUST CAP.

2 FINISH: ELECTROLESS NICKEL

REVISION HISTORY				
REV	ZONE	DESCRIPTION	APPROVED	DATE
-		INITIAL RELEASE	JM	12/01/31

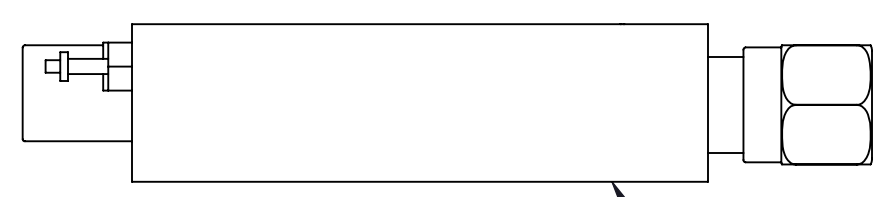
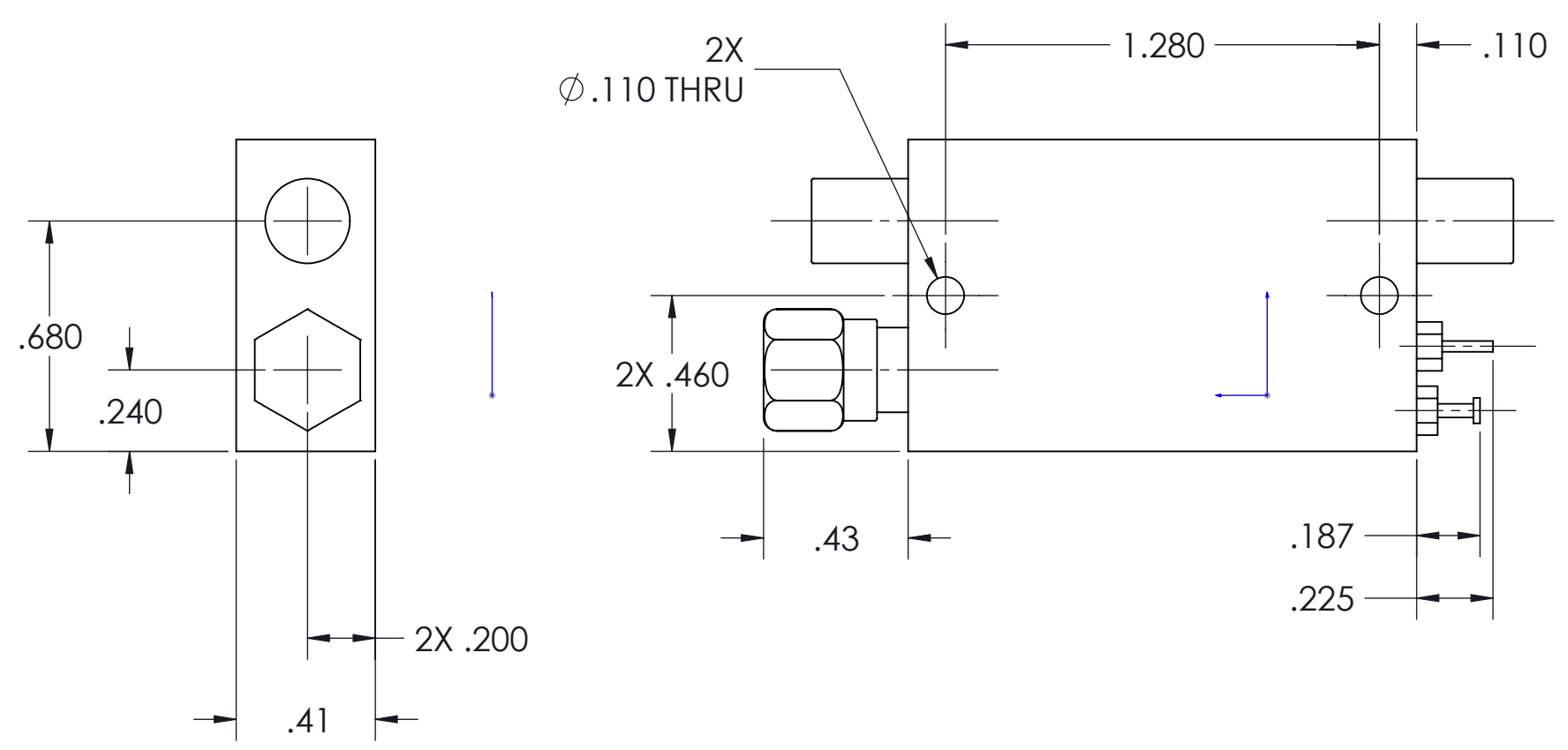
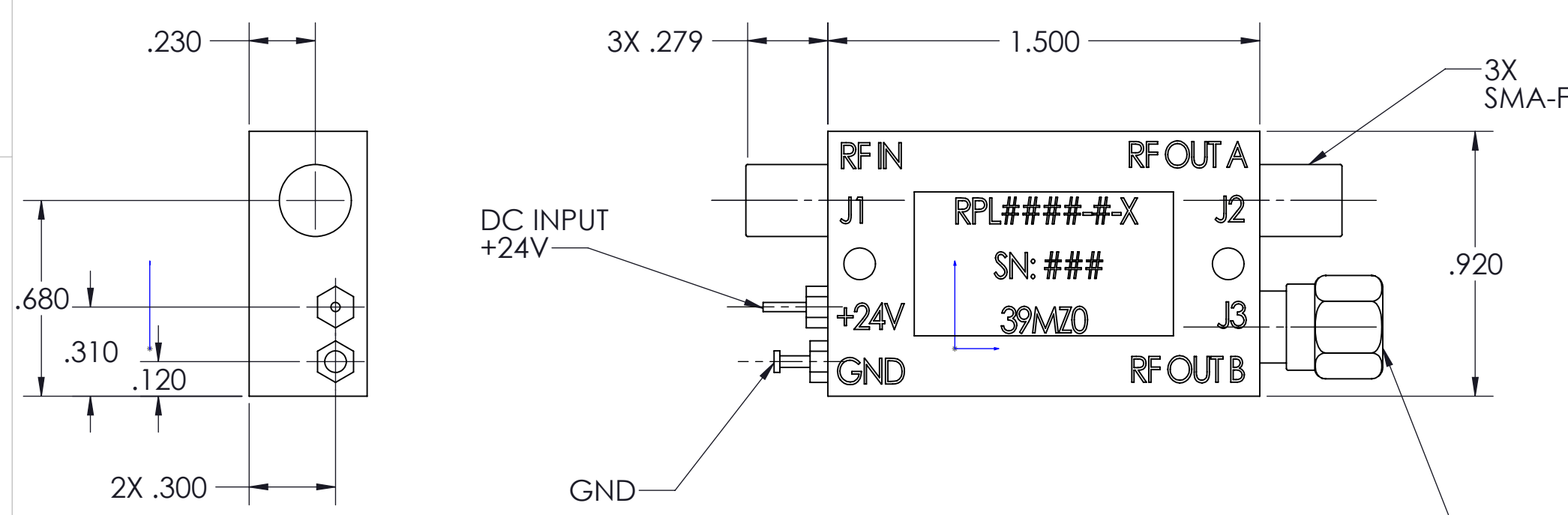

MOUNTING SURFACE

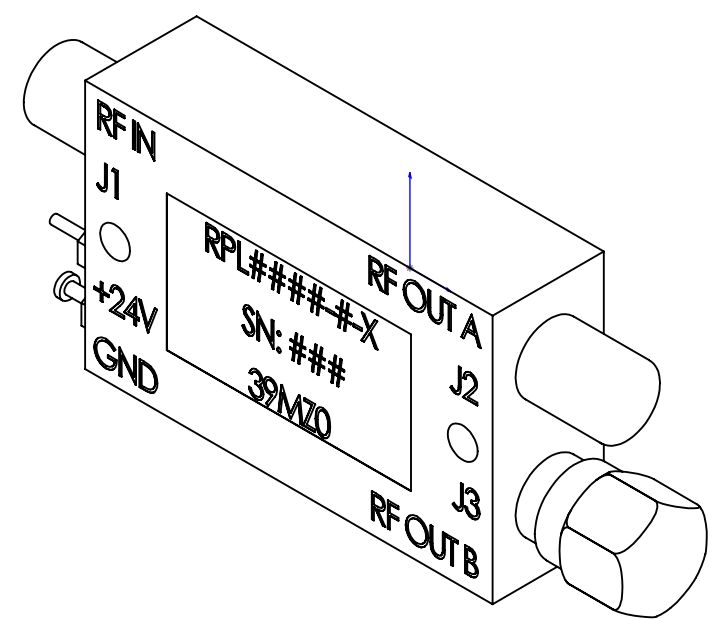

RPL0119-X-A

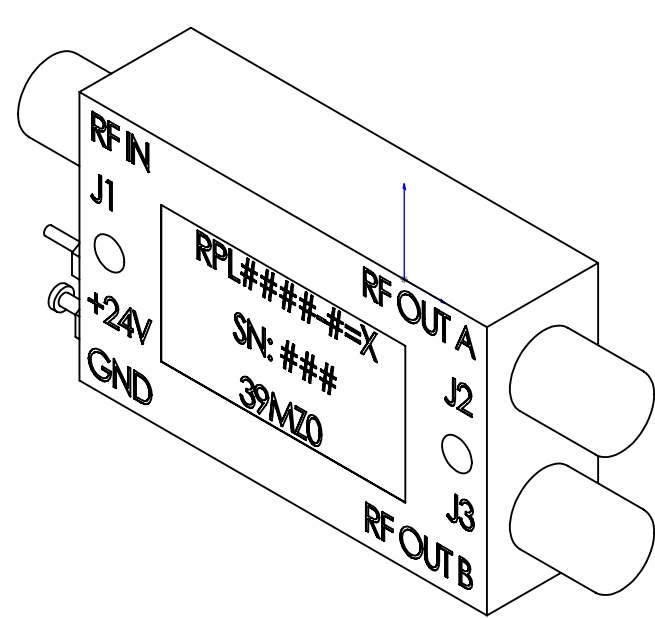

RPL0119-X-AB

PROPRIETARY AND CONFIDENTIAL  
THE INFORMATION CONTAINED IN THIS DRAWING IS THE SOLE PROPERTY OF R.A. WOOD ASSOCIATES. ANY REPRODUCTION IN PART OR AS A WHOLE WITHOUT THE WRITTEN PERMISSION OF R.A. WOOD ASSOCIATES IS PROHIBITED.

UNLESS OTHERWISE SPECIFIED:		NAME	DATE
DIMENSIONS ARE IN INCHES		DRAWN	JM 11/12/01
TOLERANCES:		CHECKED	
FRACTIONAL ±		ENG APPR.	
ANGULAR: MACH ± 1°		MFG APPR.	
TWO PLACE DECIMAL ±.02		Q.A.	
THREE PLACE DECIMAL ±.005		COMMENTS:	
INTERPRET GEOMETRIC TOLERANCING PER ASME Y14.5			
MATERIAL			
SEE NOTE 1			
FINISH			
SEE NOTE 2			
NEXT ASSY	USED ON		
APPLICATION	DO NOT SCALE DRAWING		



M06 AMPLIFIER ASSEMBLY

SIZE	CAGE CODE	DWG. NO.	REV
C	39MZO	RDC0068	-
SCALE: 2/1		SHEET 1 OF 1	